

**Darmody-Cooley-Keenan in
St. Mary's Cemetery, Salem, MA
Lot 220 on Ave. 17
Bet. St. Josephs & St. Michaels**

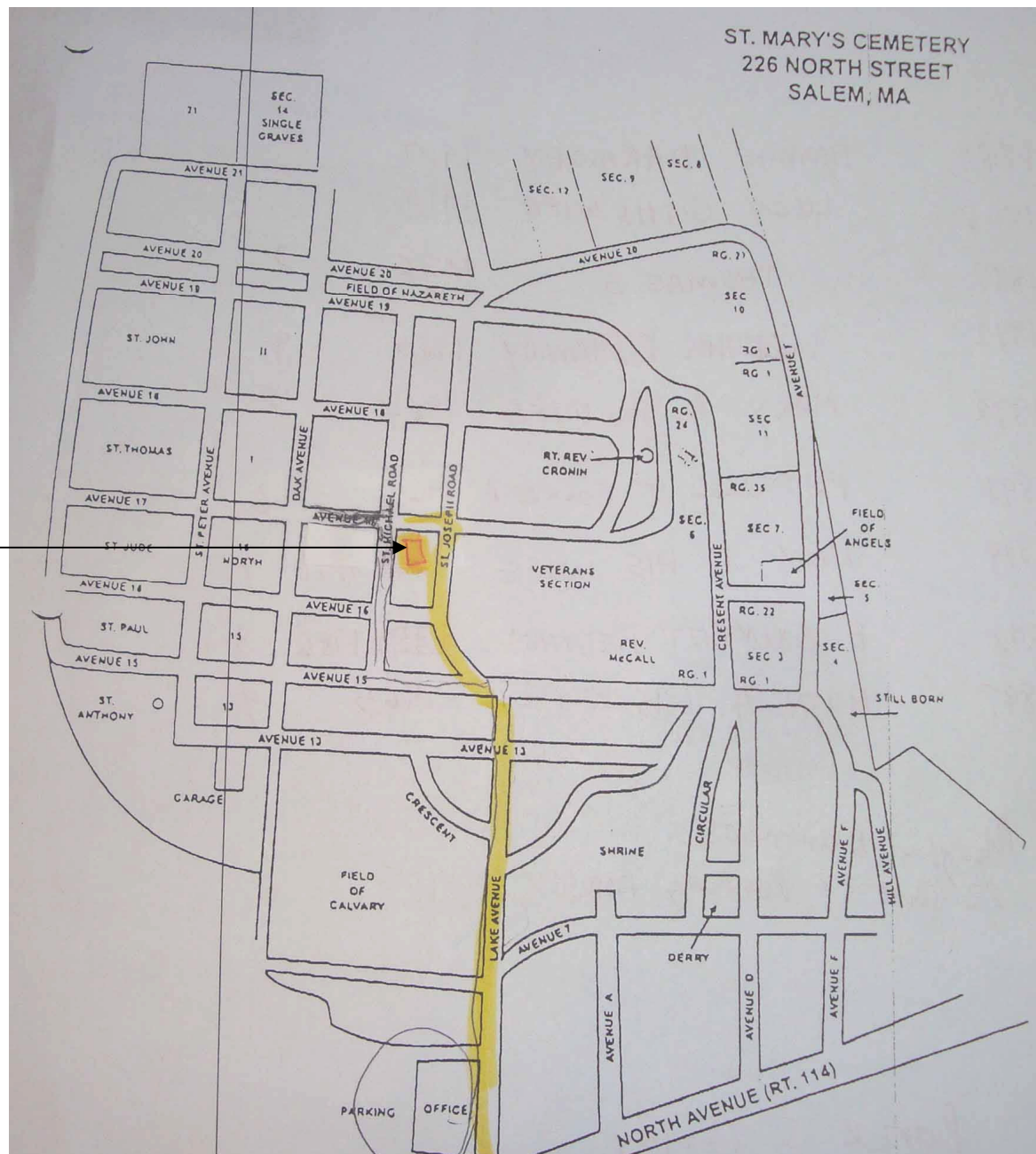

**Photos by Carol P. McCoy
27 March 2009**



The yellow line shows
The walking route to
Lot 220. The site is
Marked in red and
Yellow.

Note: there is no
Marker for Jane Darmody
Mother of Thomas.
Cemetery Records
Indicate that she is
Indeed buried here.

Sales Need At Need _____		Lot Price \$.00 _____		Grvs/Crpts/Nich 6 _____		Sq. Feet _____	
Purchase Date 09/06/1913 _____		Care Price \$.00 _____		Burial Spaces 10 _____		Lot Layout # _____	
FSC _____		Tax Code _____		Lot Dimensions 3X2X1 _____		Memorial Location _____	
Counselor _____		Sales Terms NO TERMS _____		Contract Status _____		Custom <input type="radio"/> Yes <input checked="" type="radio"/> No	

User Data		
Care Amt Note _____	Type _____	User Amt 1 \$.00 _____
GrsCrpts/Spes _____	Style _____	Cntr Pd Dte _____
Location _____	Entered By DEBRA ESTRELLA _____	P.C. Pd Dte 09/06/1913 _____

Seq	Cemetery	Location	Status	Burial Date	Deceased/Reserved	Death Date
1	SAINT MARY'S/ SAL	Sec-A17 Lot-220 Grv-FC SD	Occupied	07/27/1961	COOLEY, PATRICK J.	
2	SAINT MARY'S/ SAL	Sec-A17 Lot-220 Grv-FD SD	Occupied	12/15/1971	COOLEY, LUCY	
3	SAINT MARY'S/ SAL	Sec-A17 Lot-220 Grv-FS DD1	Occupied	10/24/1918	DARMODY, JANE	
4	SAINT MARY'S/ SAL	Sec-A17 Lot-220 Grv-FS SD	Occupied	12/11/1965	KEENAN, RUTH A.	
5	SAINT MARY'S/ SAL	Sec-A17 Lot-220 Grv-HC DD1	Occupied	09/07/1913	DARMODY, LUCY	
6	SAINT MARY'S/ SAL	Sec-A17 Lot-220 Grv-HC SD	Occupied	05/18/1960	DARMODY, WILLIAM F.	
7	SAINT MARY'S/ SAL	Sec-A17 Lot-220 Grv-HD DD1	Occupied	06/27/1936	DARMODY, THOMAS	
8	SAINT MARY'S/ SAL	Sec-A17 Lot-220 Grv-HD SD	Occupied	01/13/1964	DARMODY, MARY	
9	SAINT MARY'S/ SAL	Sec-A17 Lot-220 Grv-HS DD1	Occupied	02/25/1917	DARMODY, THOMAS	
10	SAINT MARY'S/ SAL	Sec-A17 Lot-220 Grv-HS SD	Occupied	01/28/1986	KEENAN, EDWARD	

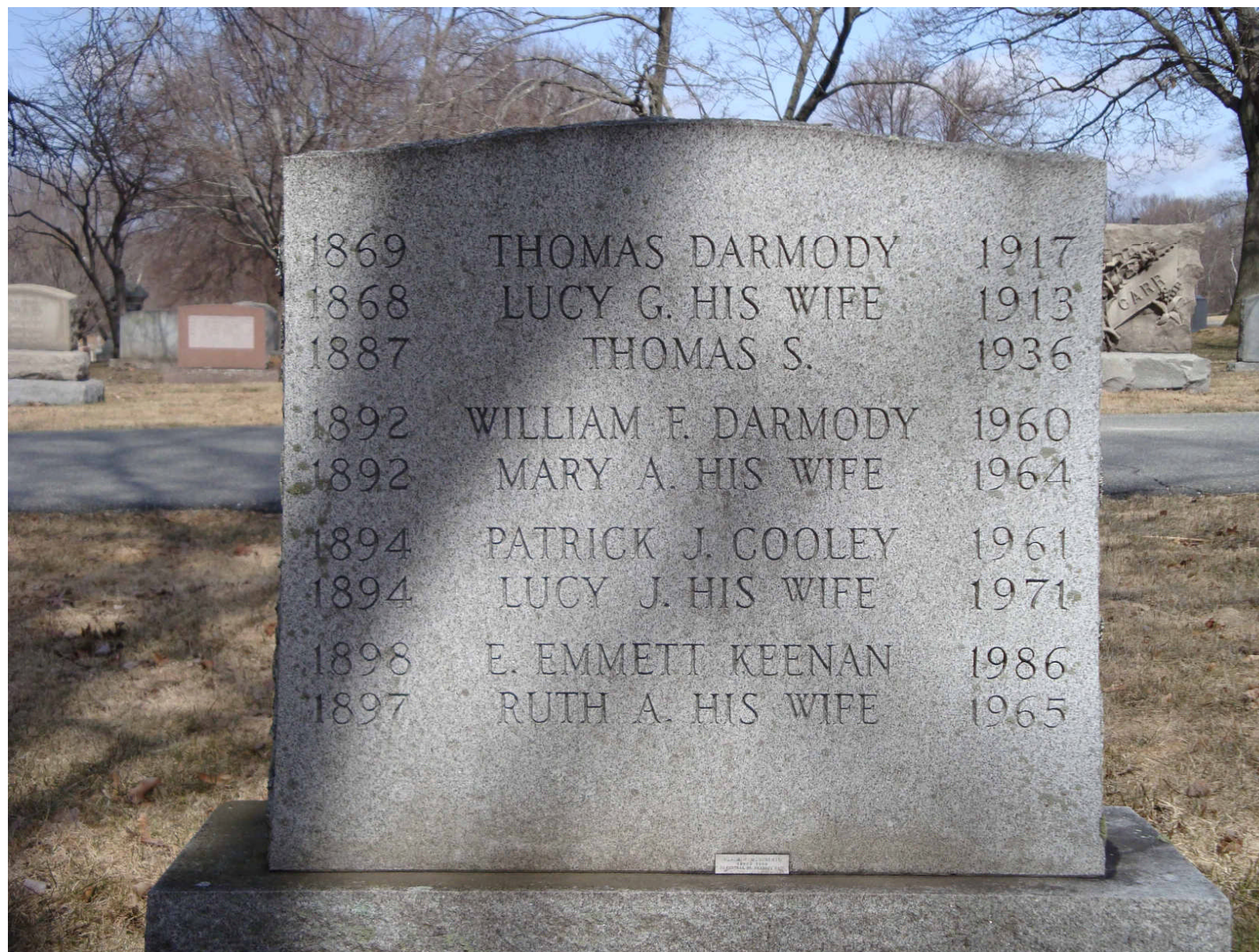

Names on the Tombstone

- 1869 Thomas Darmody 1917
 - 1868 Lucy G. His Wife 1913
 - 1887 Thomas S. 1936
 - 1892 William F. Darmody 1960
 - 1892 Mary A. His Wife 1964
 - 1894 Patrick J. Cooley 1961
 - 1894 Lucy J. His Wife 1971
 - 1898 E Emmett Keenan 1986
 - 1897 Ruth A. His Wife 1965
-
- NOTE: There is no marker for Jane Darmody, who is definitely on record with the Cemetery as being buried there!



Avenue 17, Lot 220. Between St. Joseph's and St. Michaels

Patrick J. Cooley

- MASS
- SGT Co. D 5 Pioneer Infantry
- WWI
- 26 April 1894 to 24 July 1961
- He has a separate marker which is flat in the earth. That was the only separate marker I could find.